

DETALHE DA CALHA DOS BLOCOS DE PAVIMENTO E ANTEBRÇOS

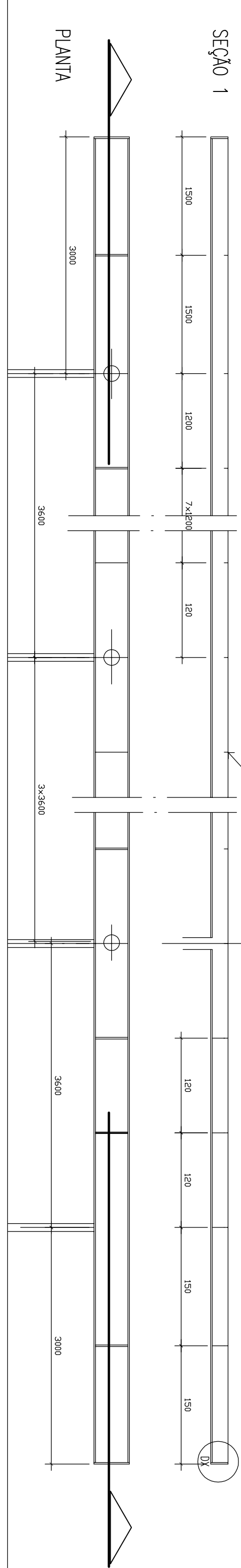

DETALHE DA CALHA DAS PASSARELAS DUPLAS

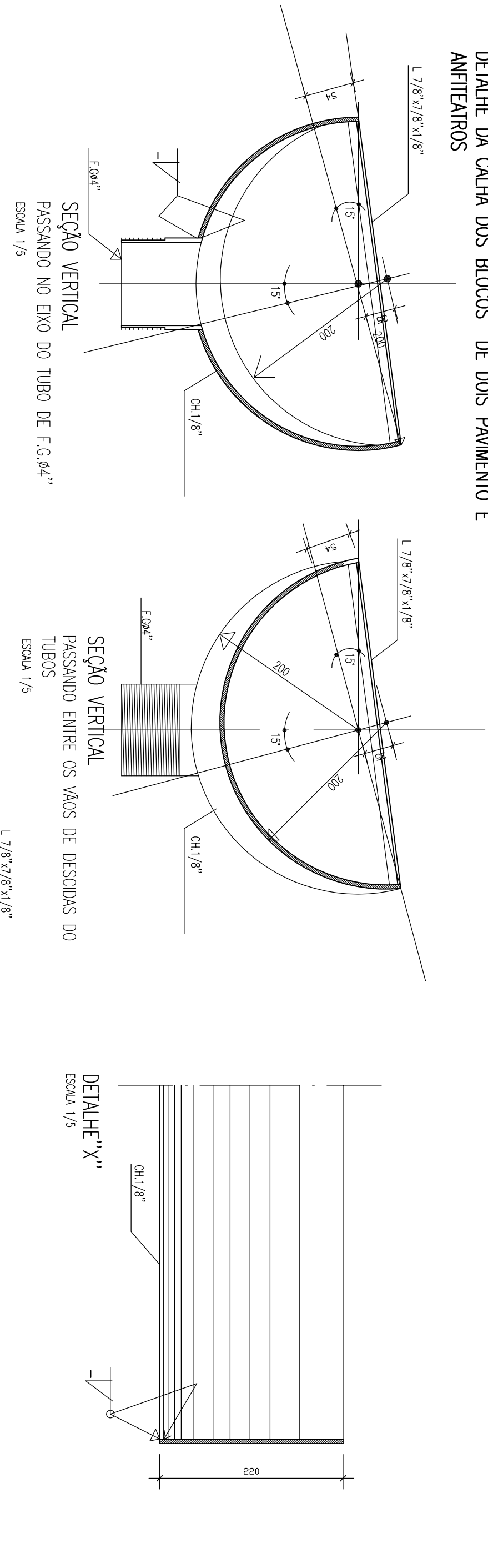
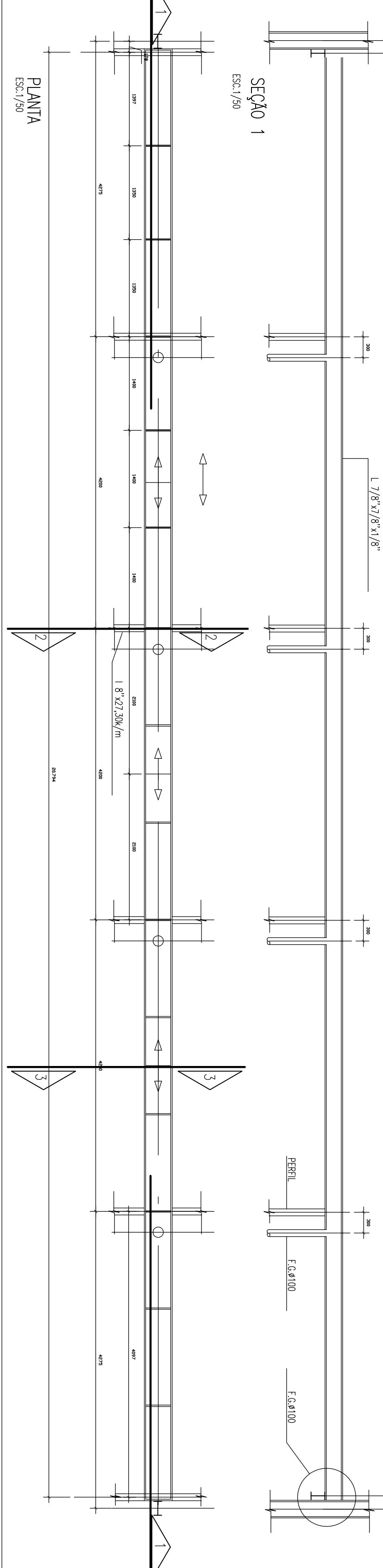
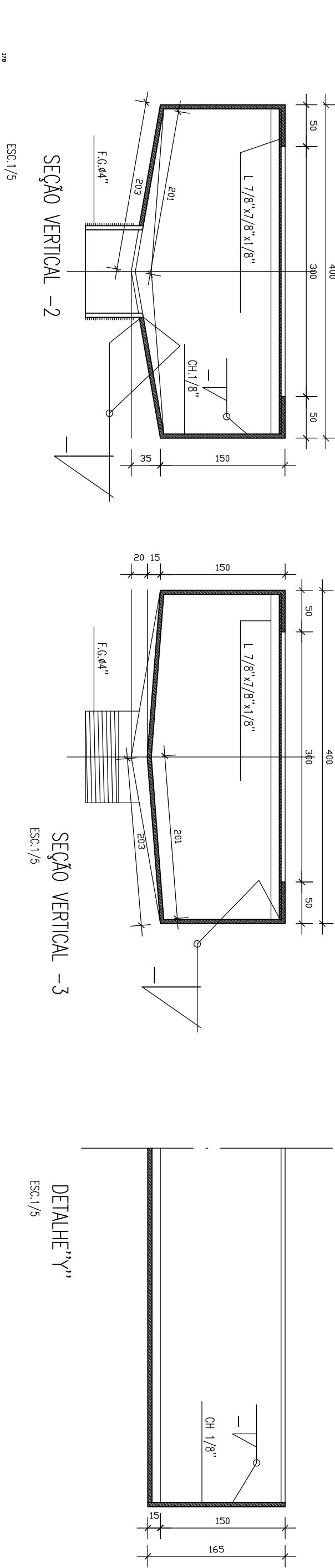

DETALHE DA CALHA ENTRE OS BLOCOS DE CANTINA E AREA DE LAZER

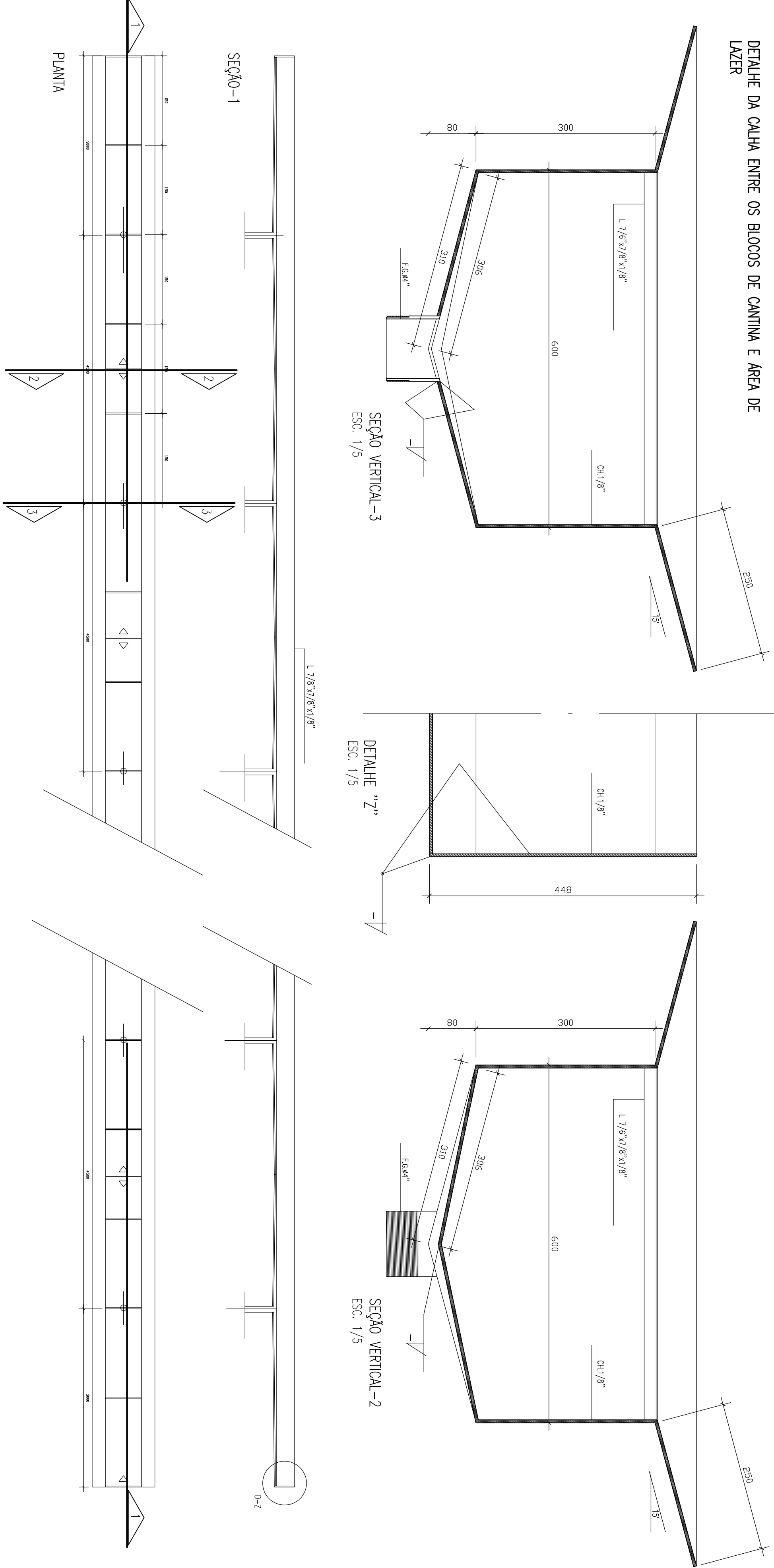

NOTAS:

- AS CORTAS ESTÃO EM mm
- AS CORTAS ESTÃO EM mm
- TODOS OS FLETES DE SOLDA TÊM A ESPESSURA DO ELETRODO 3/16"
- TODA A ESTRUTURA SERÁ EXECUTADA EM AÇO CARBONO NÍVELO DA CL. SIDERURGICA NACIONAL.

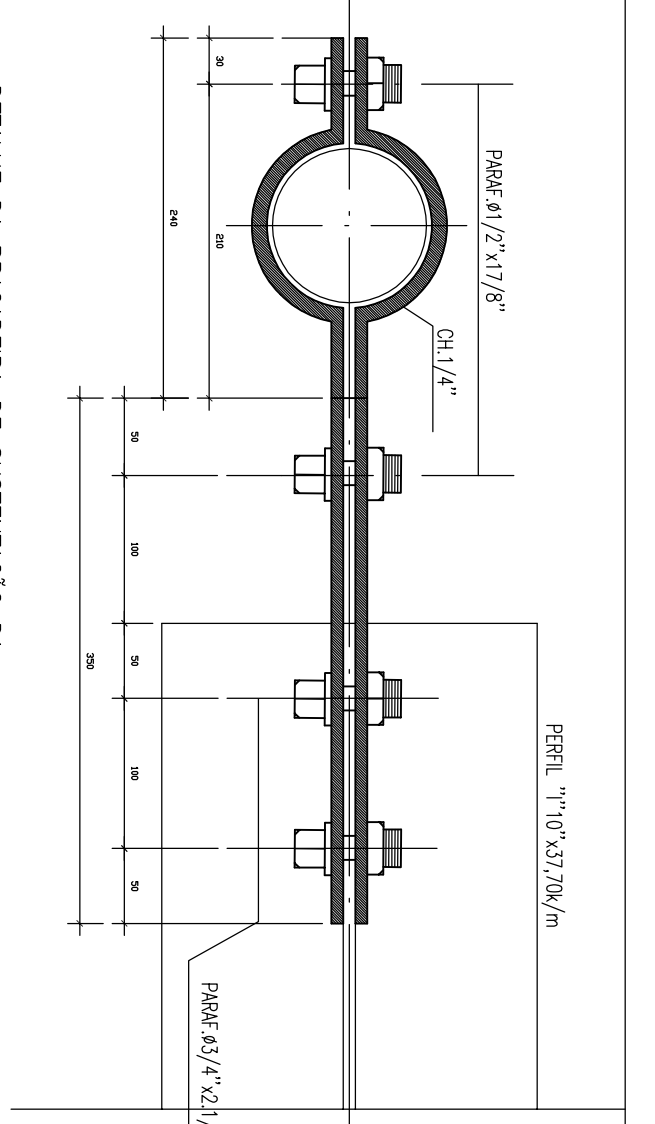
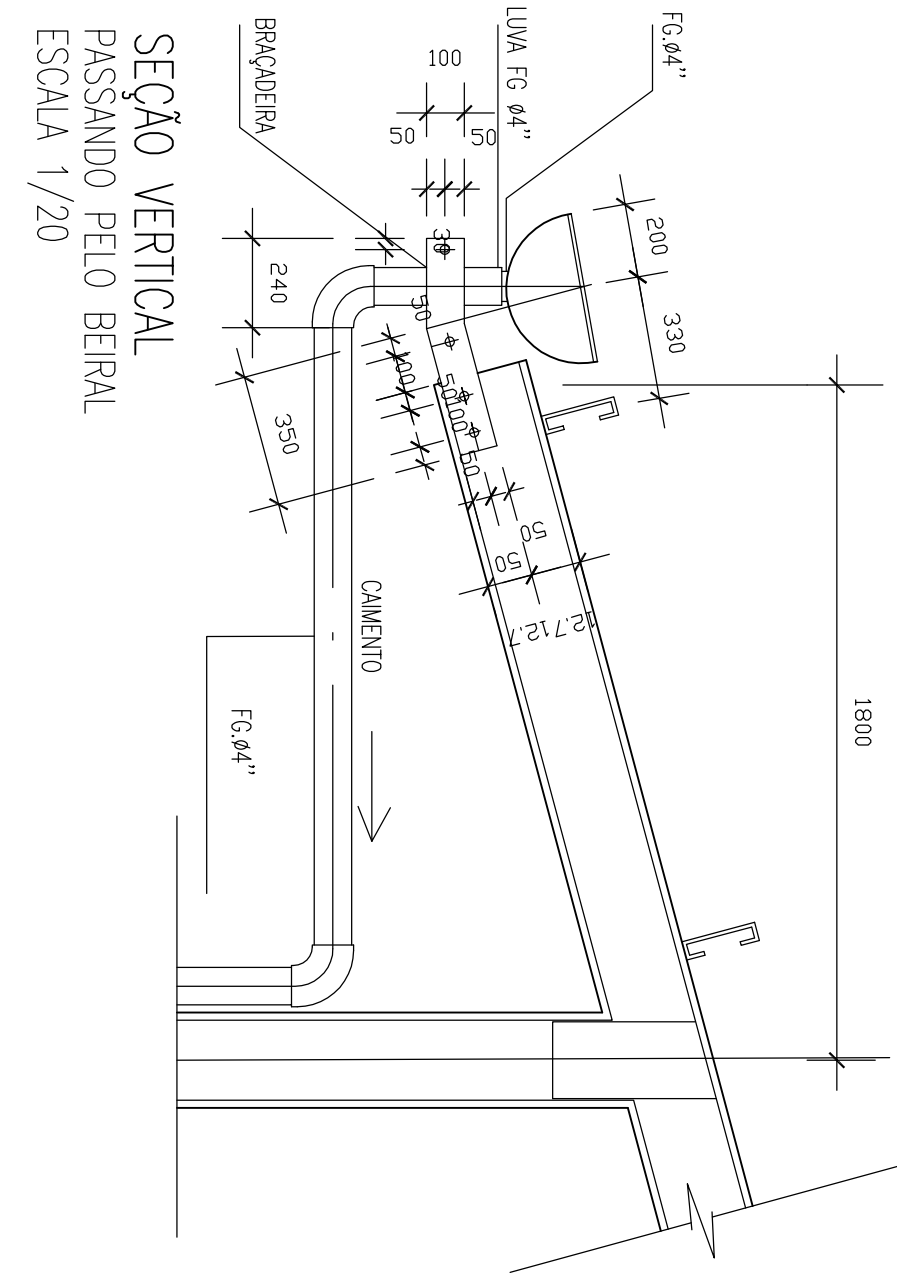

DETALHE DA BRANQUEIRA DE SUSTENÇÃO DA CALHA/ANTBRÇOS DO TUBO DE FIBRO D'ALUMINIZO 4"

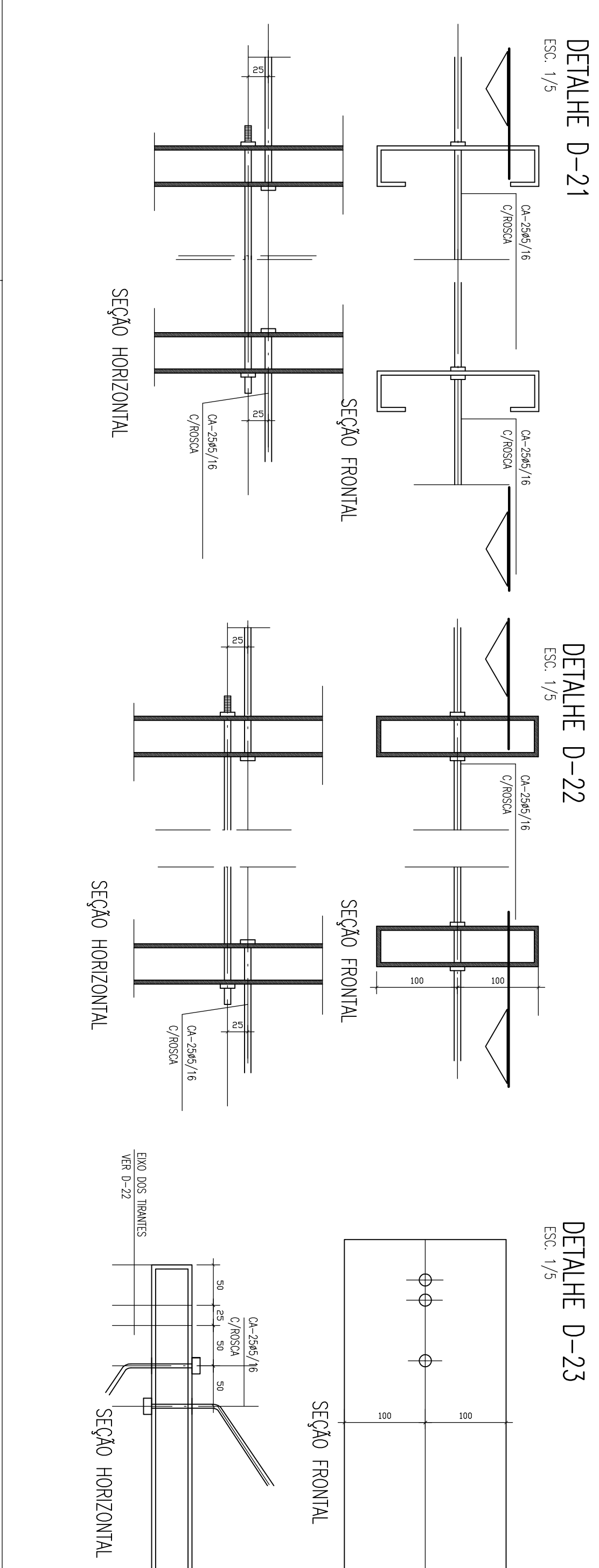

DETALHE D-18

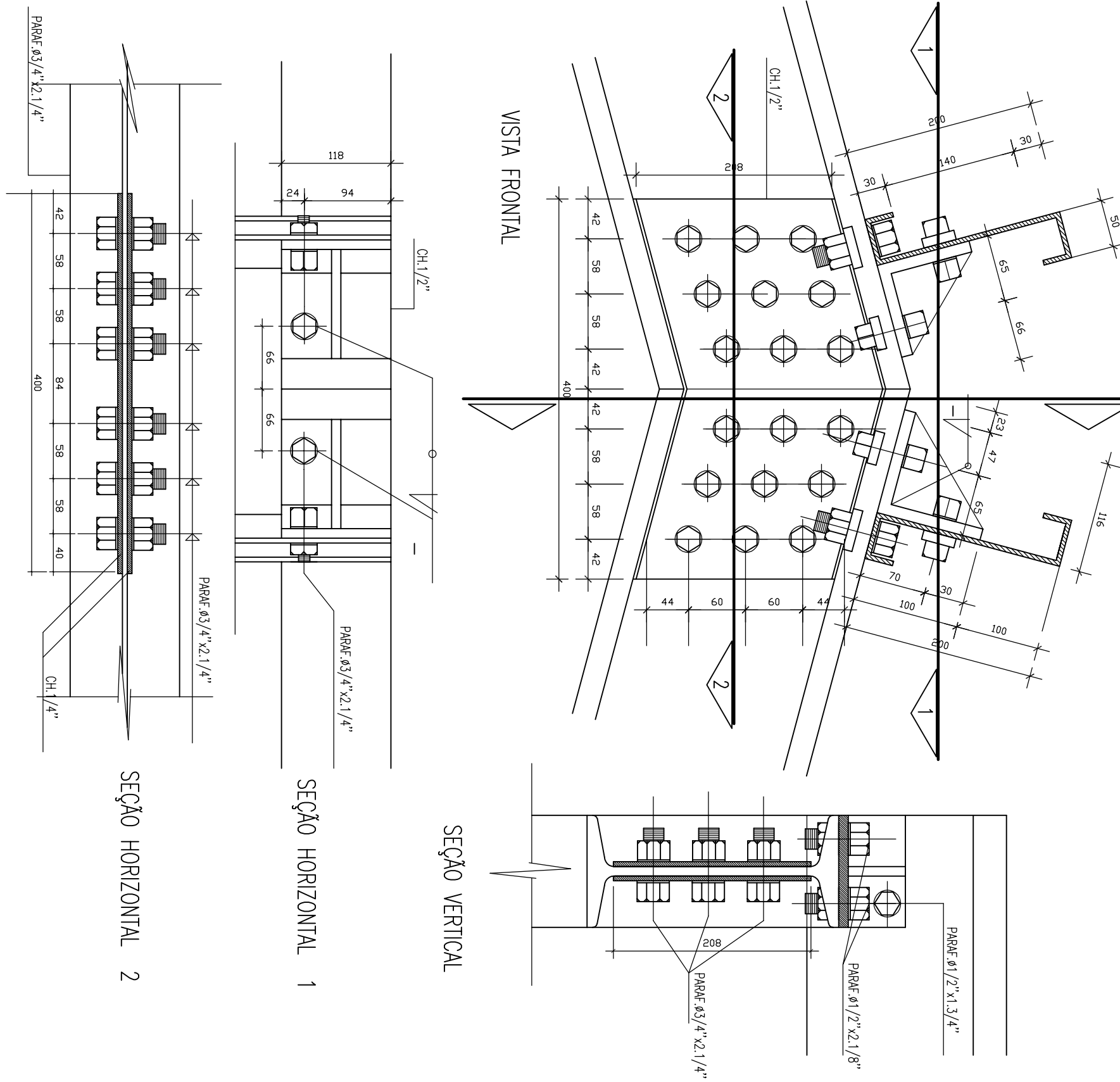

DETALHE D-19

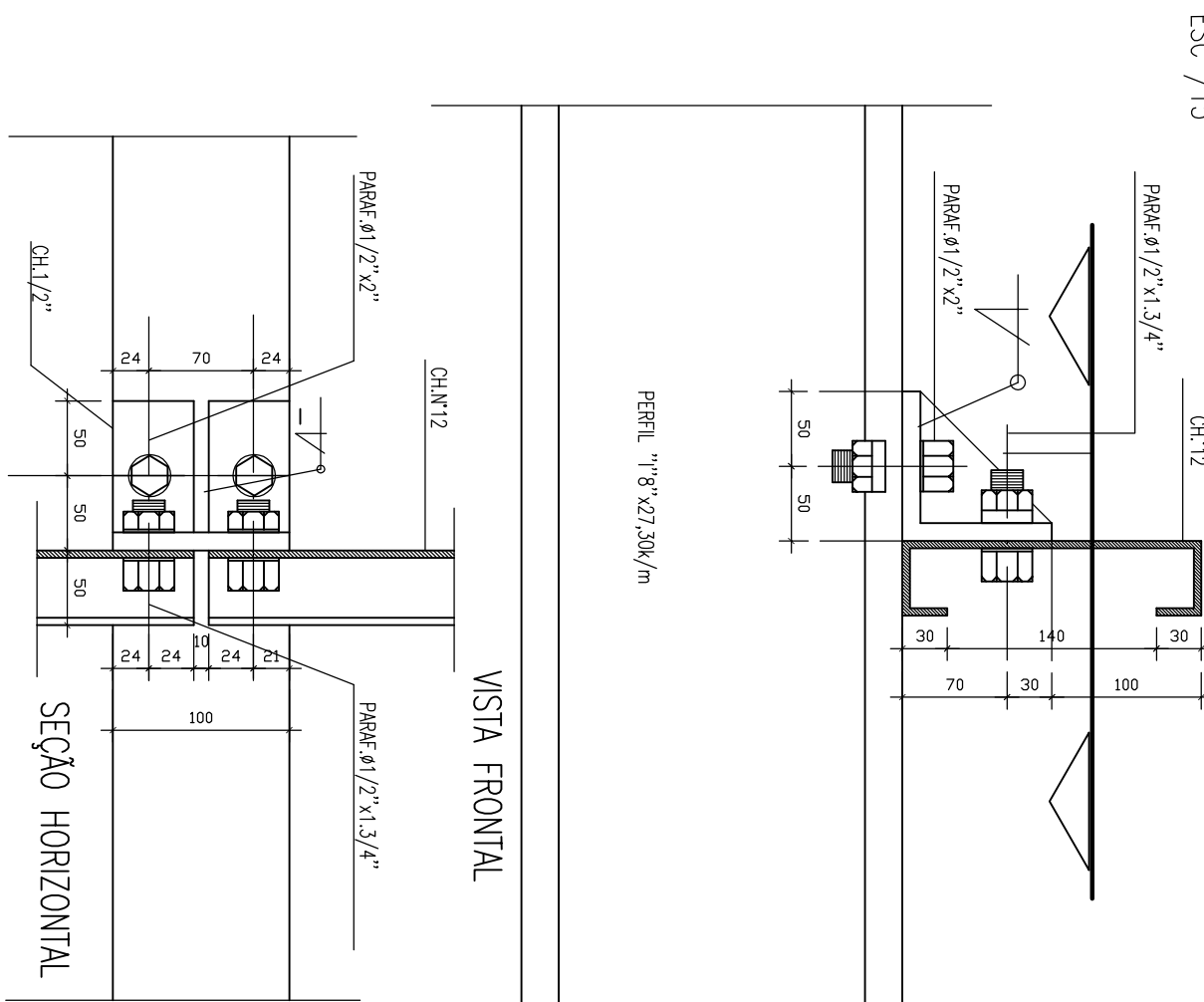

DETALHE D-19

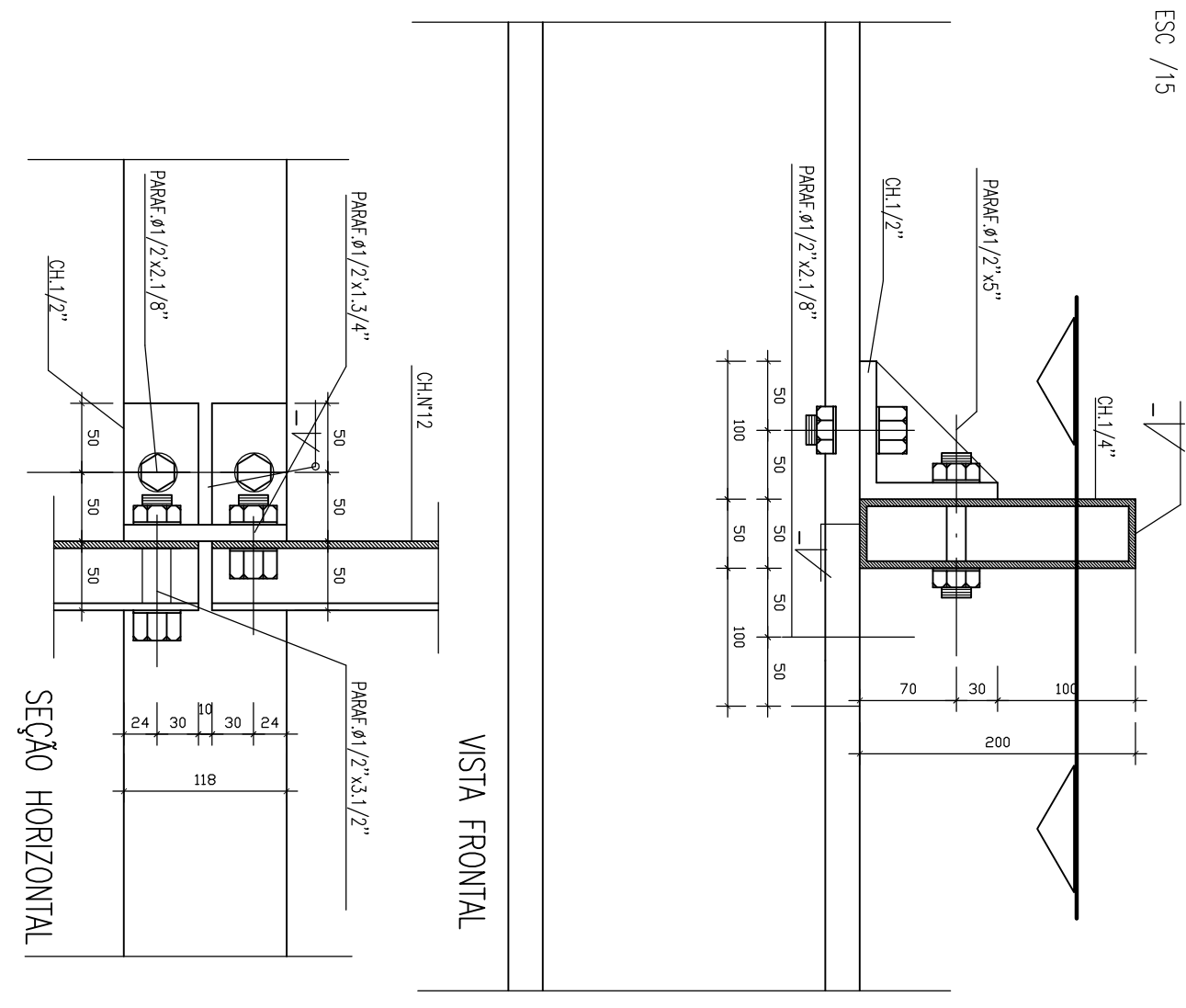

DETALHE D-24

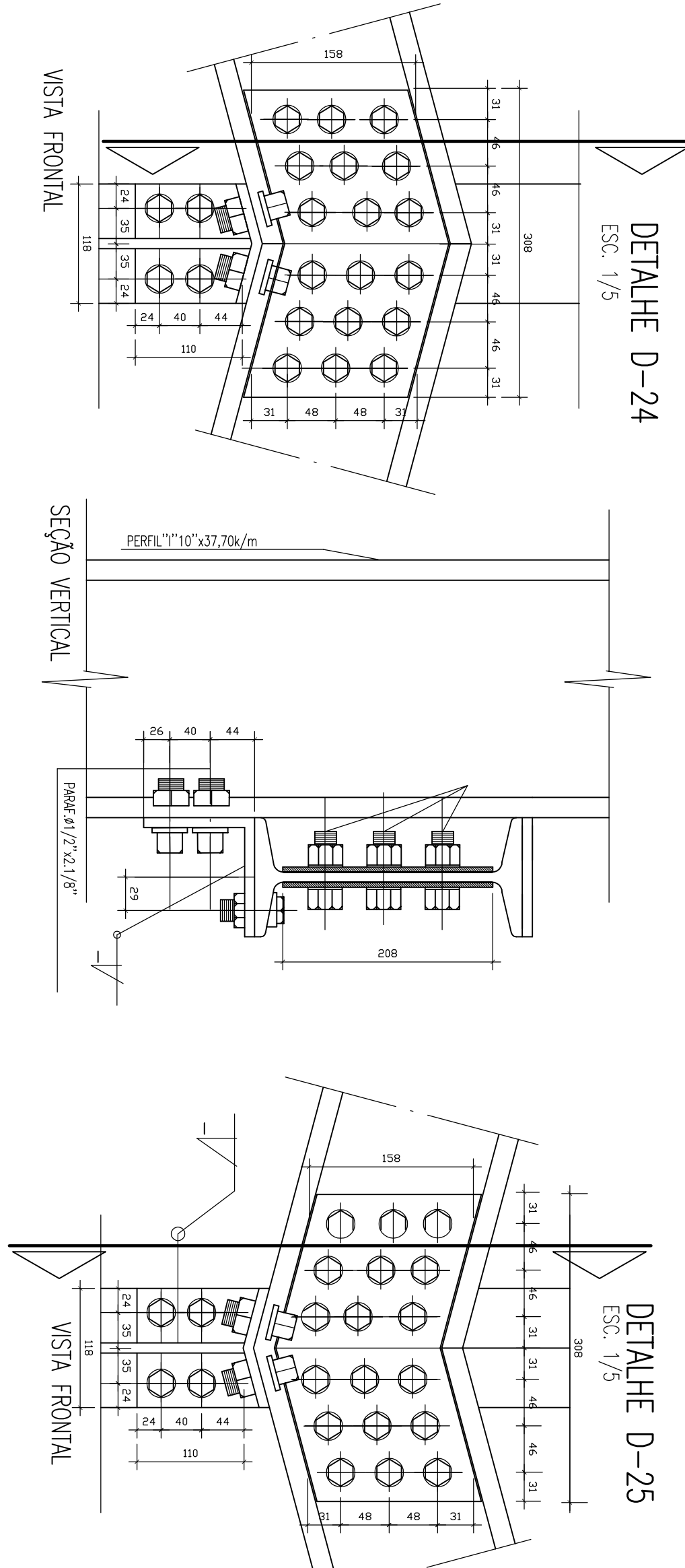

DETALHE D-25

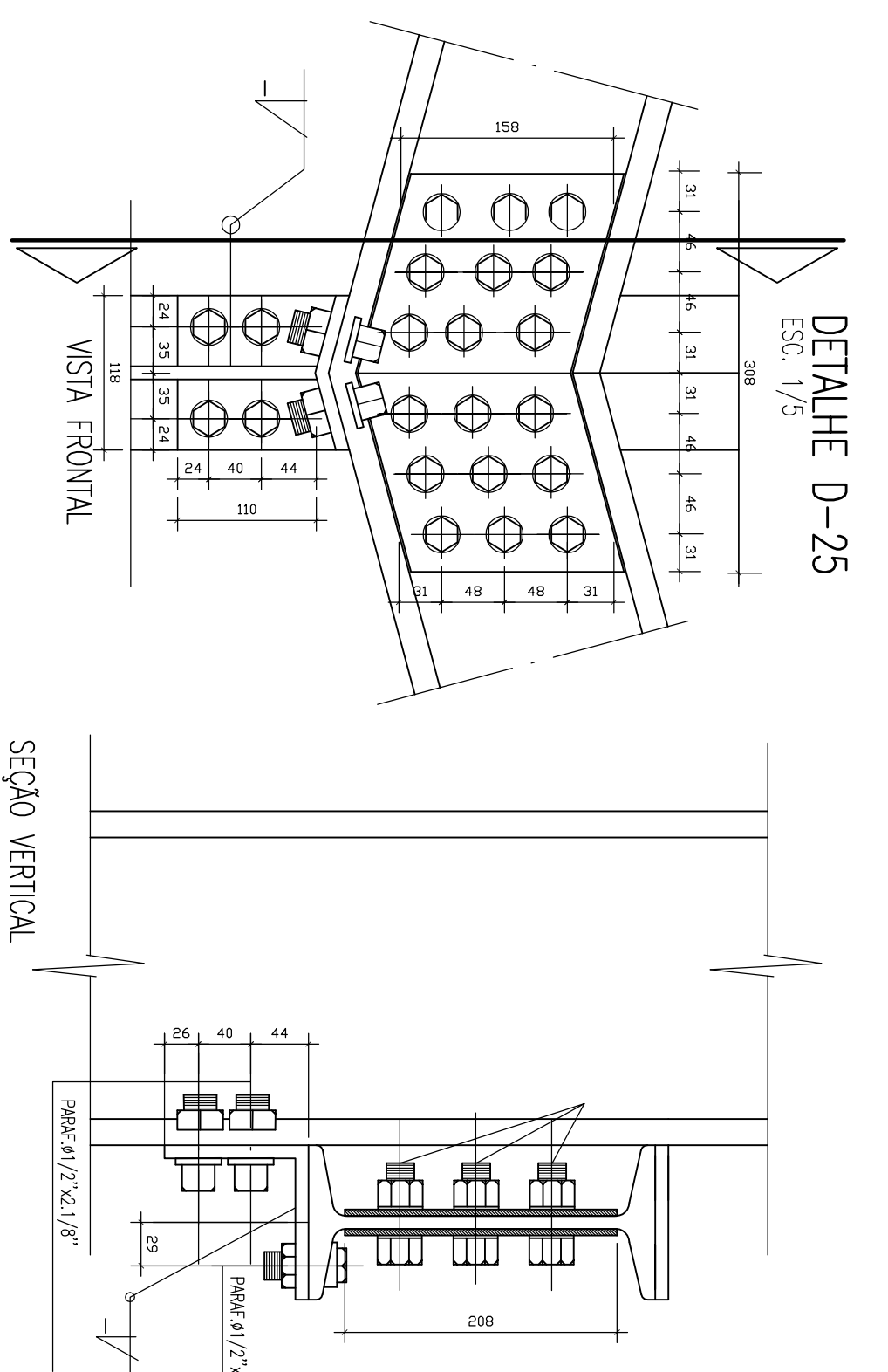

DETALHE D-27

